

**EXPEDITION SERIES  
5" Vertical Posts  
ZIPPER CLIMBER**

**USER GROUP:** 5-12 years

**RECOMMENDED CREW:** 1 person

**TOOLS REQUIRED:**

T-30 TORX Tool (supplied by Playland)

3/16" Allen Head Wrench

Level

High Speed 3/8" Electric Drill w/Clutch

**NOTE:** Use of any other driver may result in damage to tool and/or hardware!

**INSTALLATION TIME:** Approximately 1 hour

**WEIGHT:** 79 lbs.

**CONCRETE REQUIRED:** 3.14 Cubic Feet

**PRE-INSTALLATION CHECK:**

Compare all items received to the packing list. Notify Playland immediately if any parts are missing or damaged.

**Playland is not responsible for items discovered missing after 72 hours from time of delivery!**

Before beginning installation, make sure that you have read and understand the *Installation Introduction* manual that was supplied to you by Playland. If you did not receive a copy, or if you have a question regarding anything covered in this manual, call us for assistance at 800-356-4727.

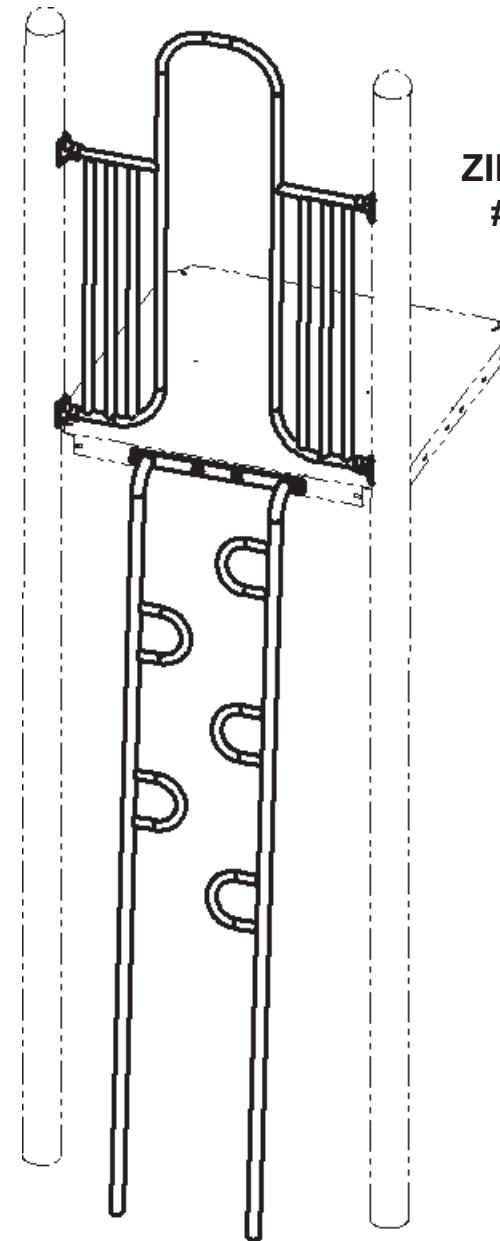

**ZIPPER CLIMBER  
#TEX01001XX**

### STEP 1

Refer to PLAN VIEW and FOOTING DRAWING to determine location of zipper climber.

### STEP 2

Excavate footing holes as shown in footing elevation and footing detail. Place a 2" spacer in bottom of each hole.

### STEP 3

Select zipper climber, four 3/8"x1" security TORX head bolts, eight 3/8"x1-1/4" flat washers and four 3/8" standard nuts. Set zipper climber in place. **NOTE:** Zipper climber will be attached to four inside holes of deck -- two outermost holes will not be used. From outside of deck insert bolt through washer, climber, deck, washer and into nut (see Detail A). Repeat for remaining three sets of hardware. Tighten all.

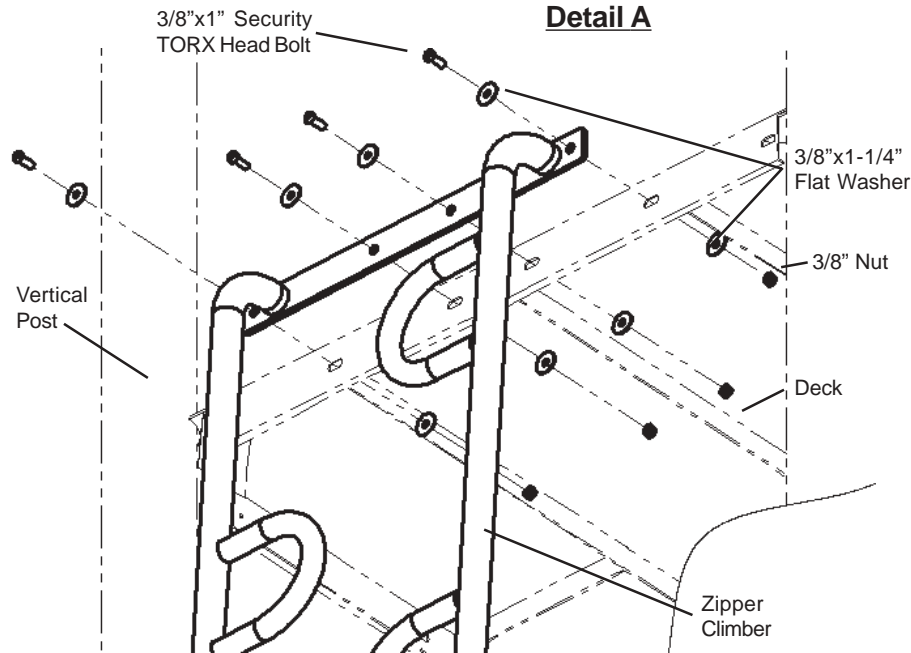

### STEP 4

Select four C-Line component pipe fittings and four adhesive gaskets for C-Line fittings. Remove backing from one side of gasket and press on to back of fitting (see Detail B). **NOTE:** Gasket is covered with a strong adhesive - do not press on to fitting until gasket is centered. Repeat for other gaskets and fittings.

#### Detail B

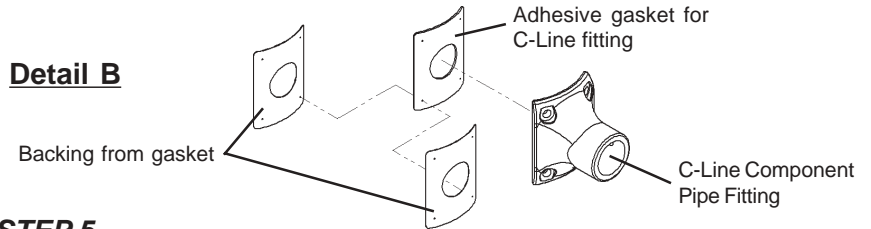

### STEP 5

Select four C-Line component pipe fittings with gaskets attached, four 3/8" set screws and one gated entry - plain. Slide fittings over gated entry as shown in Detail C. Install and gently tighten set screws. Remove backing from other side of fittings. Set gated entry in place above deck. **NOTE:** Center of bottom fitting of gated entry will be 3-5/16" above top of deck. Center of top fitting of gated entry will be 42-3/16" above top of deck. Verify gated entry is level, plumb and at correct height. Press clamps into position. **NOTE:** Gasket is covered with a strong adhesive -- do not press clamps on to post until gated entry is positioned correctly.

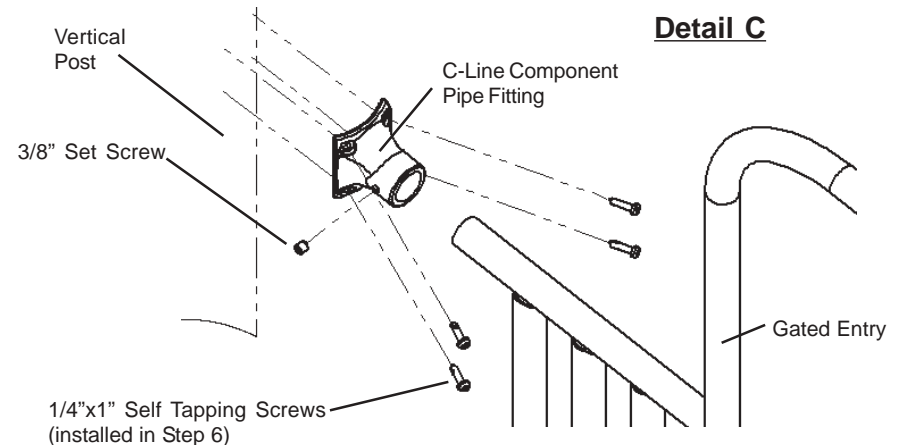

**STEP 6**

Select sixteen 1/4"x1" self tapping TORX head screws. Secure each fitting to vertical post by installing four screws per fitting. Lightly tighten until all four screws are installed. Then tighten all four self tapping screws (see Detail D). **NOTE:** Must use high speed 3/8" electric drill with clutch. Use of any other driver may result in damage to tool and/or hardware. Repeat for all four fittings.

**STEP 7**

Tighten all hardware.

**STEP 8**

Pour concrete in footings to correct level. **Allow concrete to harden for at least 48 hours.**

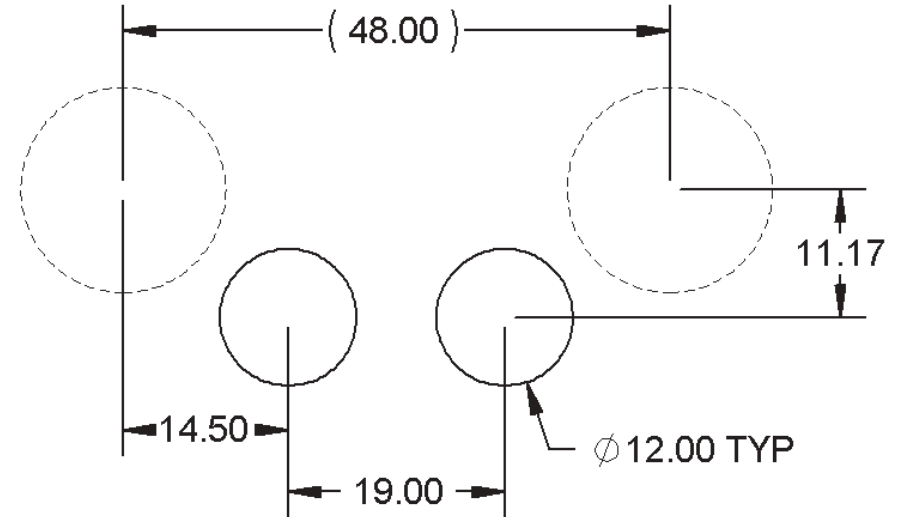

**FOOTING LAYOUT**

**BILL OF MATERIALS  
PARTS / HARDWARE LIST**

ITEM #	QTY.	PART NO.	DESCRIPTION
1	1	AFB41092XX	Fab Wdmt. - Zipper Climber
2	1	AFB40965XX	Fab. Wldmt. Gated Entry Plain 5" C-Line
3	4	CTG10410XX	Fitting - 5" C-Line Component Pipe (Coated)
4	4	10200501XX	Adhesive Gasket - C-Line Fitting 5"
5	16	2080000192	Screw - 1/4"x1" Self Tapping Torx w/Patch
6	4	2080040192	Set Screw - 3/8"x3/8" Allen Head
7	8	2090010292	Washer - 3/8x1-1/4 Flat
8	4	2080011192	Bolt - 3/8"x1" Security Torx w/Patch
9	4	2100040292	Nut- 3/8" Standard

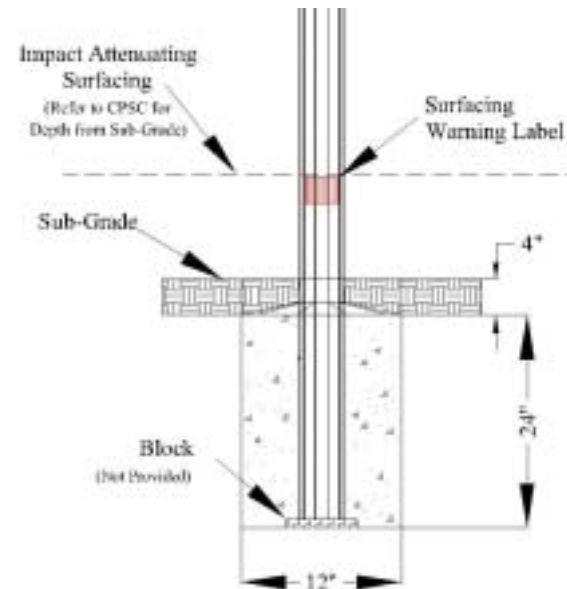



**OVERHEAD VIEW**

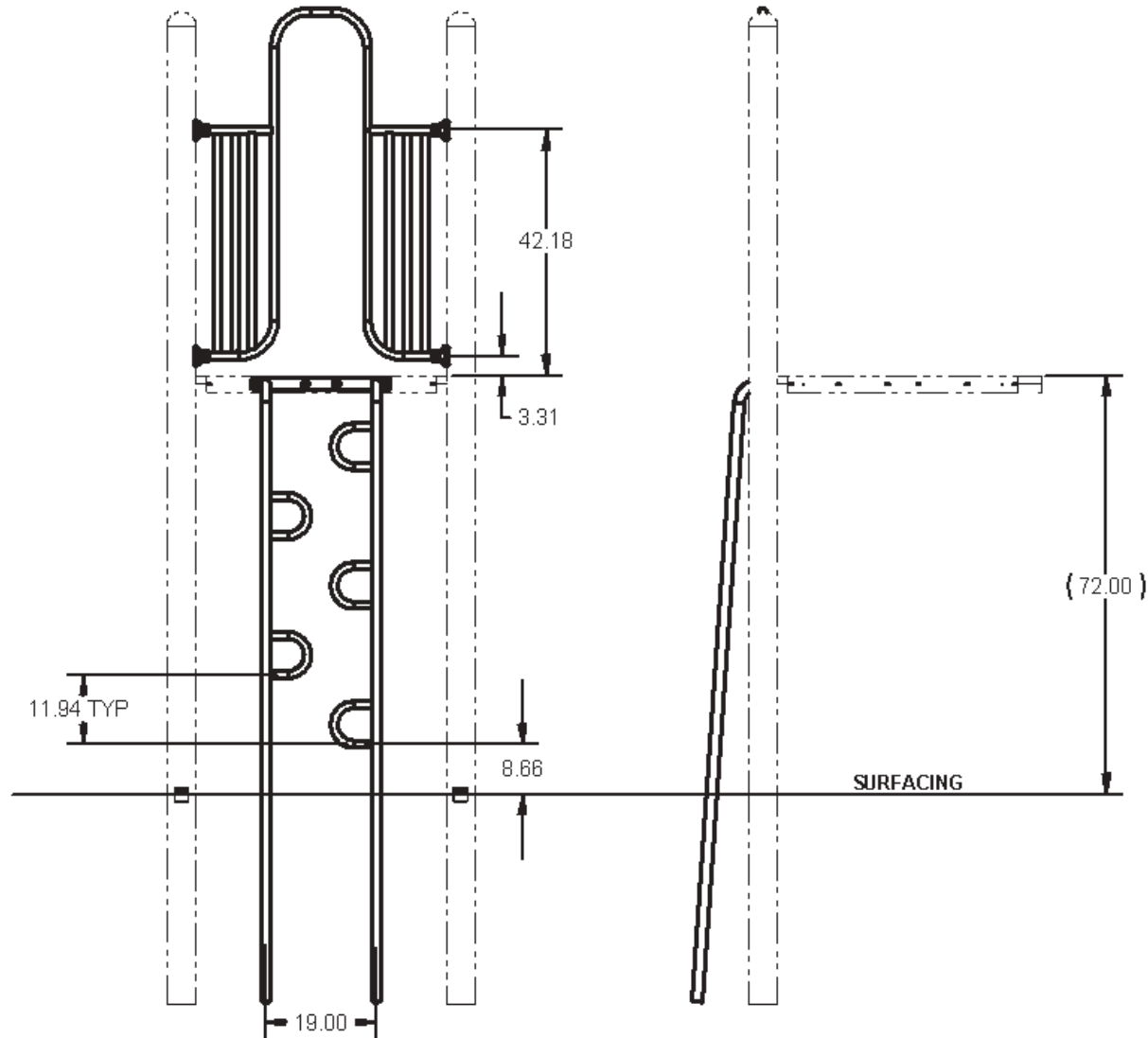

**ELEVATION VIEW**

**SIDE VIEW**

## PRODUCT SPECIFICATIONS

### **FITTINGS**

- Aluminum alloy (GM70B) manufactured and tested in accordance with the following ASTM Standards: B179-68, B108-68, E10-66, E8-66
- Powder coat finish
- Predrilled
- Limited lifetime warranty

### **ADHESIVE GASKET**

- Neoprene rubber
- 60 +/- 5 durometer hardness
- Double sided adhesive
- Limited lifetime warranty

### **HARDWARE**

- Type 304 (18-8) stainless steel
- Conforms to ANSI/ASCE-8-90
- 84 ksi tensile strength
- 42 ksi yield strength
- Tamper resistant
- Special tool required for install
- Limited lifetime warranty

### **SUPPORT PIPE**

- 1.66" O.D. round steel tube
- 13 gauge steel
- 50,000 psi yield strength (ASTM E-8)
- 55,000 psi tensile strength (ASTM E-8)
- Triple zinc coated undercoat
- Powder coat finish
- Limited 15-year warranty

### **HAND/FOOT HOLDS**

- 1-1/4" O.D. round steel tube
- 14 gauge steel
- 50,000 psi yield strength (ASTM E-8)
- 55,000 psi tensile strength (ASTM E-8)
- Triple zinc coated undercoat
- Powder coat finish
- Limited 15-year warranty

**PRODUCT SPECIFICATIONS****GATED ENTRY**

- 1-1/4" O.D. round steel tube
- 14 gauge steel
- 50,000 psi yield strength (ASTM E-8)
- 55,000 psi tensile strength (ASTM E-8)
- Triple zinc coated undercoat
- Powder coat finish
- Limited 15-year warranty

**PRETREATMENT WASH PRIMER**

- 4860-420 primer / 1000-44 activator
- Polyvinyl-butyril resin based primer
- Used on all milled steel and all weld joints
- Designed to give adhesion to a wide variety of metal substrates
- Provides added metal protection against rust
- Imparts extra durability to topcoat (powder coat)
- When reduced properly, it meets the definition of a "pretreatment" primer found in many air quality regulations

**POWDER COAT FINISH**

- TGIC Polyester
- Electrostatic application
- Baked-on @ 400 degrees
- 5-7 mills thick
- Lead free
- High gloss
- No peel / No flake finish
- Resistant to salt spray (ASTM B117)
- Resistant to humidity (ASTM D2247)
- Direct/Indirect impact 120 in. pounds (ASTM D2794)
- Good to excellent resistance to most solvents, oils, acids and alkalis
- 13 color options